

TYPE:

PROJECT:

CATALOG#:



Product Features

GIT-TOPLine11 is a track and magnet lighting profile that comes with end caps to attach onto the ends of the profile. It has optional recessed, suspension, tack and magnet mount available. It works perfectly as accent lighting and is recommended to use with Green Image Tech's strip lights, model GS-50XID.

Product Specifications

Model	GIT-TOPLine11
Length	2500 mm
Dimensions (mm)	17 x 11.7 mm
Material	Anodized Aluminum
Max LED Strip	12.4 mm
Cover Options	Clear, Milky, or Frosted

Technical Drawing

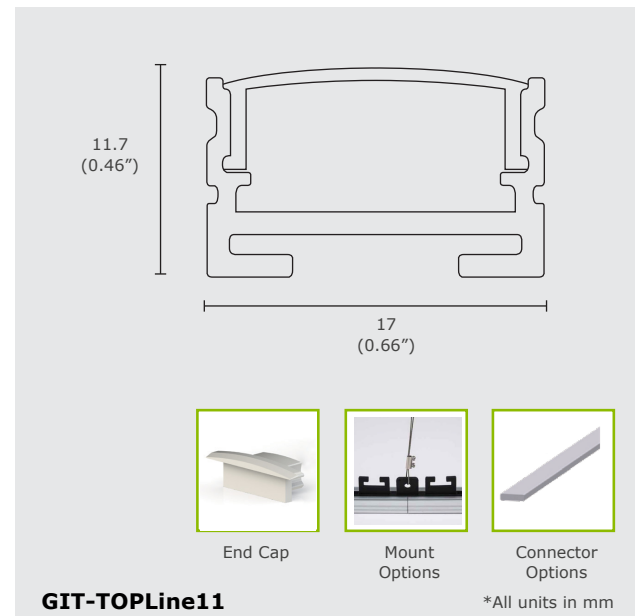

5 YEARS LIMITED WARRANTY INCLUDED

Order Form

TOPLine		-		-		-		-		-		-		-	
Series		2		3		4		5		6					
2. MODEL	3. LENGTH	4. COVER OPTIONS		5. MOUNT OPTIONS		6. CONNECTOR OPTIONS									
11 11	2500 2500 (2.5m)	C Clear	M Milky	R Recessed	T Track	ST Standard	TS T-Shape								
		F Frosted		S Suspension	M Magnet	MN Min	90 90°								

TYPE:

PROJECT:

CATALOG#:

Accessories

Mount Options

The INLine and TOPLine series also has the option of track mounting or magnet mounting (not pictured below).

Suspension

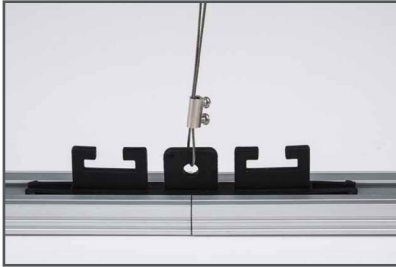
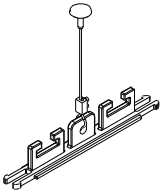

Recessed

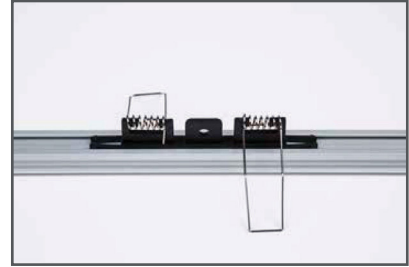
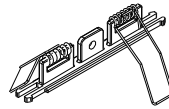

Connector Options

The INLine and TOPLine series has the option of manipulating the length and shape of the profile via the usage of connectors

Standard

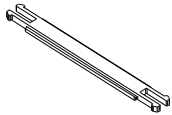

Mini

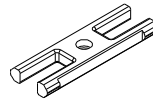

90°

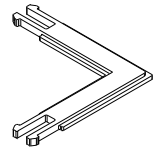

T-Shape

